

#	DESCRIPTION	PART NUMBER	QTY
1	Tubo collettore / Down pipe	9773H088S2A	1
2	Tubo di raccordo / Link pipe	9773H088S2B	1
3	Silenziatore / Muffler - db killer 50.DK.096.0	GP	1
4	Protezione in gomma per staffa / Rubber protection for bracket	50.73.077.1	1
5	Staffa / Bracket	50.SS.241.1	1
6	Vite M6 x 12 / Screw M6 x 12	50.72.024.1	2
7	Rondella M6 / Washer M6	50.72.027.1	4
8	Dado M6 / Nut M6	50.73.146.1	2
9	Vite M8x80 / Screw M8x80	50.73.072.1	1
10	Rondella in alluminio / Aluminium washer	50.73.063.1	1
11	Distanziale in alluminio / Aluminium spacer (Øe.30 Øi.8,5 h.35)	50.SS.053.1	1
12	Boccola / Bush	50.73.381.1	2
13	Silentblock / Silentblock	50.73.380.1	2
14	Dado M8 flangiato / Flanged nut M8	50.73.393.1	1
15	dB Killer	50.DK.081.0	1
16	Molla media / Mid-size spring	50.73.359.1	3
17	Tubo in gomma per molla / Rubber pipe for spring	50.73.049.0	3

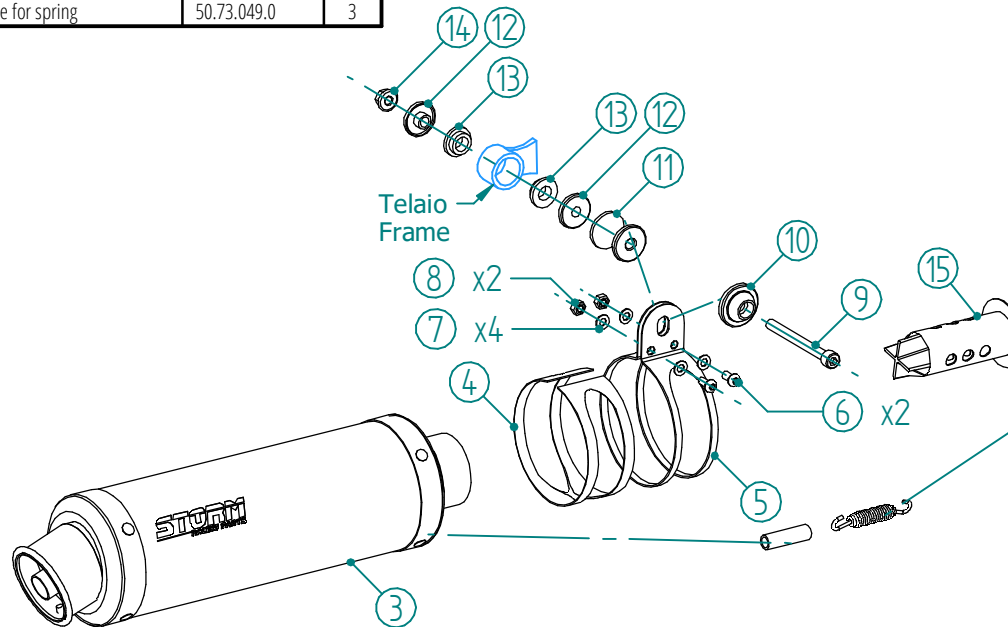
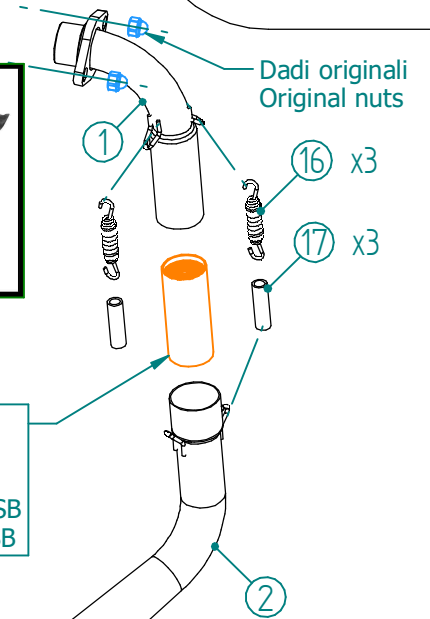

APPLICAZIONI / APPLICATIONS				
CODICE / CODE	SILENZIATORE / MUFFLER	TUBO / PIPE	FASCETTA / CLAMP	NOTE
74.H.088.LXSB	STEEL BLACK	INOX / ST. STEEL	INOX / ST. STEEL	CATALYTIC CONVERTER NOT INCLUDED
74.H.088.KXSB				CATALYTIC CONVERTER INCLUDED