

#	DESCRIPTION	PART NUMBER	QTY
1	Fascetta Ø 74/79 mm / Pipe clamp Ø 74/79 mm	50.FA.013.1	1
2	Tubo di raccordo / Link pipe	9773KT031S2	1
3	Dado rapido M8 / Cage nut M8	50.73.913.1	1
4	Rondella in alluminio nera / Black aluminium washer	50.73.221.1	1
5	Vite M8x40 / Screw M8x40	50.73.075.1	1
6	Vite M8x20 / Screw M8x20	50.73.894.1	1
7	Rondella in alluminio / Aluminium washer	50.73.063.1	1
8	Dado M8 flangiato / Flanged nut M8	50.73.393.1	2
9	Staffa / Bracket	50.SS.1132.0	1
10	Vite M8x50 / Screw M8x50	50.73.088.1	1
11	Silenziatore / Muffler - db killer 50.DK.021.0	GP	1
12	Protezione per staffa / Bracket protection	50.73.040.1	1
13	Staffa / Bracket	50.SS.001.0	1
14	Tubo in gomma per molla / Rubber pipe for spring	50.73.049.0	1
15	Molla corta / Short Spring	50.73.123.1	1

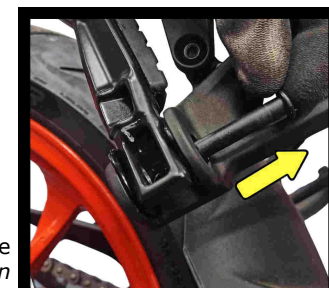

Rimuovere il perno originale
Removing the original pin

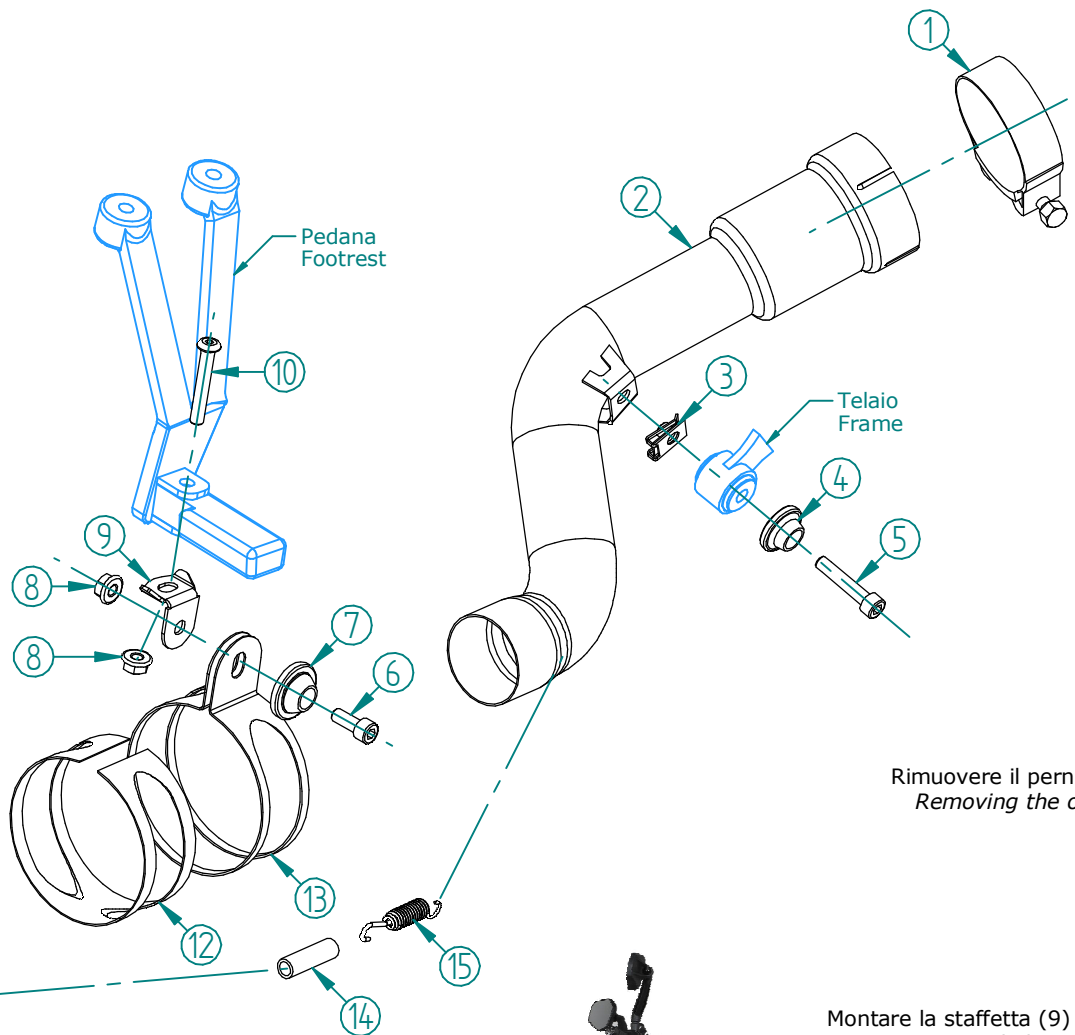
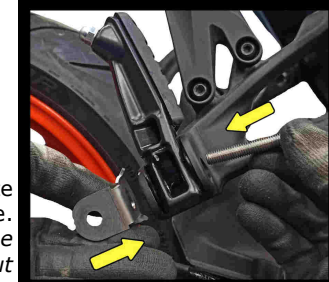

Montare la staffetta (9) con la vite
e dado in dotazione.
Mount the bracket (9) with the
supplied screw and nut

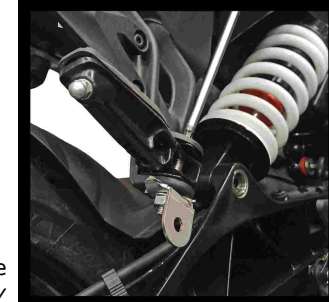

Montaggio finale
Final assembly



APPLICAZIONI / APPLICATIONS			
CODICE / CODE	SILENZIATORE / MUFFLER	FASCETTA / CLAMP	TUBO / PIPE
74.KT.031.LXSBC	STEEL BLACK	INOX / ST. STEEL	INOX / ST. STEEL